

EVM8810

1000W 100V Controller / Master



EVS8820

1000W 100V Slave Extension



EVM8810 Rear View



EVS8820 Rear View



Introducing an integrated voice alarm controller from Amperes. It is suitable for small scale installations of up to 24 zones, which is compact and containing all components essential for EVAC and BGM system. As such, it is not only providing substantial savings on rack space but also overall costings of building up a small system with individual components.

The core of the system is the **EVM8810** which is a master unit which has built in 1000W 100V with 8 zones of speaker lines. If the overall installation requires more than 8 zones, the output channels can be further expanded by using **EVS8820**. Additional 2 extensions can be added to make overall installation to be 24 zones.



- **Integrated** voice alarm controller with media player for USB MP3, FM tuner and Bluetooth
- BGM playback - priority paging sequence in **compliance** with fire regulations / BS / EN54 standards
- **Auto amplifier fault sensor (AFS)** which monitor the amp circuit with built in standby amplifier changeover
- **Cascadable** to 24 zones for larger setup
- **Flexible addressing** which allows integration with existing Amperes PA setup
- 4 **EVAC message** memory banks with remote and front panel button playback
- **Compatible** with any Amperes PD series of paging microphone, PT1801 MKII, F16000 and external EP1200
- **Zone expansion** with TD6400 if only single EVM8810 is used without the need of extra EVS8820
- **Relay contacts** available for external volume controllers overriding when emergency paging / message activated



Features in Summary

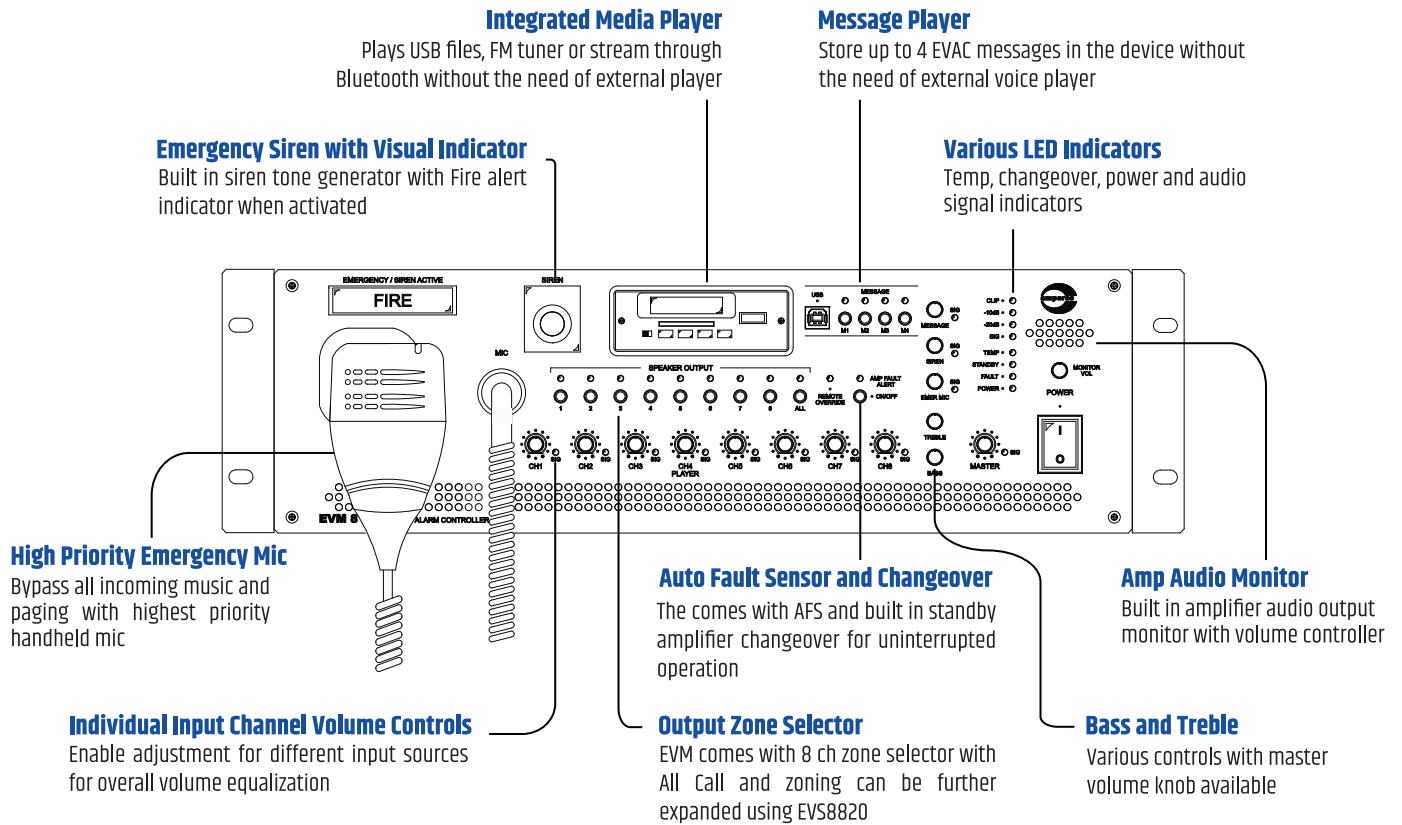

Application Concept

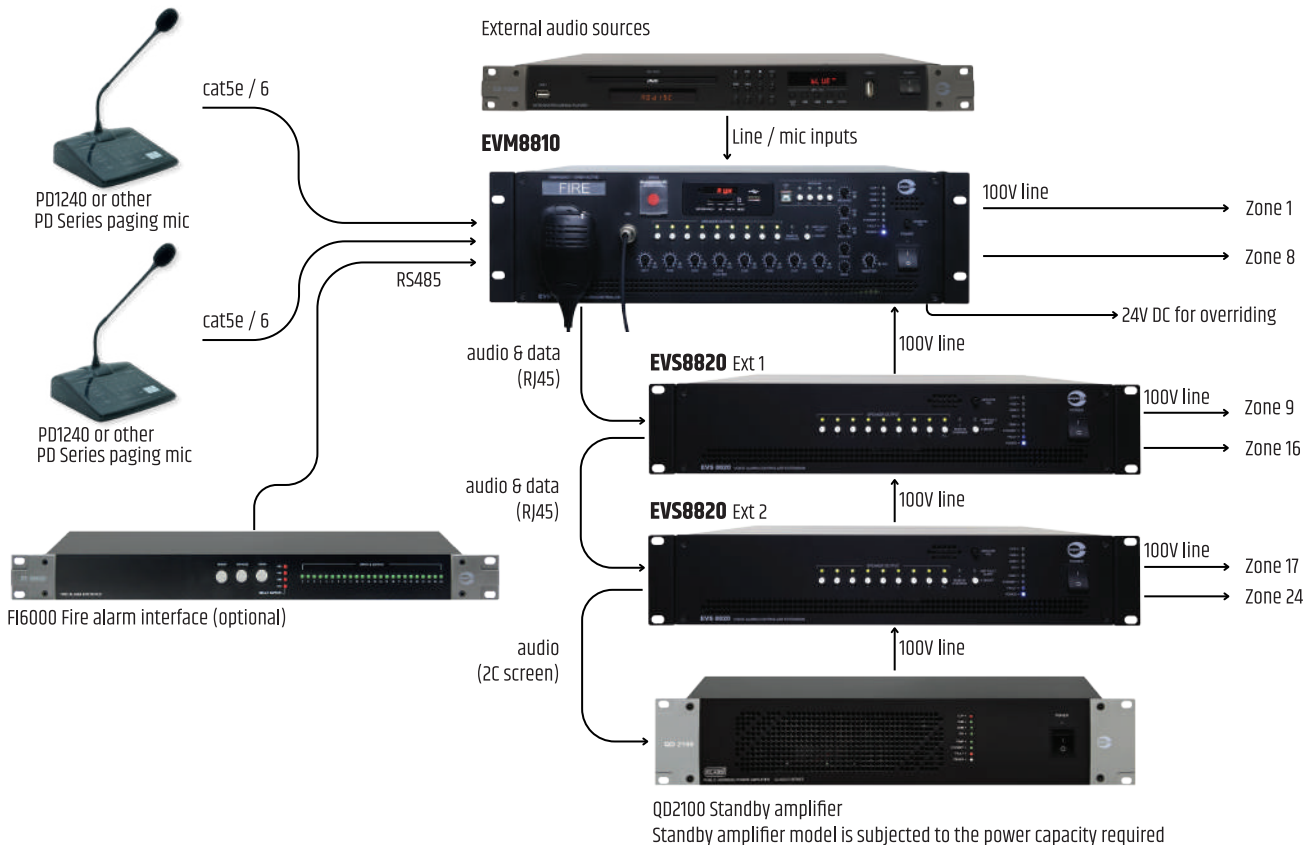

Technical Specifications

	EVM8810	EVS8820
POWER REQUIREMENTS		
Power supply	220 - 240 V AC : 50 / 60 Hz	
Power rating (W at 100V line)	1000W at 100 V line output	
Power consumption (full load) : 240V ac	1500 VA (6.1A)	
Standby current at 240V ac	0.5 A	0.4 A
INPUTS		
Input channels	Ch 1 to 6 Mic / Line balanced, RCA x 2 Handheld PTT mic, message bank x 4 Siren, PD paging mic x 2 ports, USB / MP3 / FM / BT External EP mic port	Link line level : 0 dBu
Input sensitivity / impedance	Mic : 40 mA / 10k Ohm Line : 1.2 V / 10k Ohm	Line : 1.2 V / 10k Ohm
Input signal at standby	Switchable auto detect / always ON	
Frequency response	20 - 18 kHz (+/- 3 dB @ 1 kHz, 0 dBu)	
THD (+ Noise)	< 1%	
Standby amplifier changeover	Built in changeover relay	
OUTPUTS		
Zone output	8 zones (front switch and remote paging with All Call)	
Audio output	Master line output, balanced 0 dBu	
Audio link to slave	Line balanced 0 dBu	
Emergency dry contact	3A ; NO relay	
Tone controls	Bass (100 Hz), Treble (10 kHz), 15 dB slope	
Output audio monitoring	Front speaker with volume controls	
CONTROLS / COMMUNICATION		
Controls	Individual channels, message, siren, emergency mic, bass & treble, master volume	Output volume
Communication control	RS485 ; 19.2 kbps	
Cascade / link	RJ45 port (line audio and RS485 data)	
Cascade quantity	3 nos (total 24 zones)	
Indicators	Signal, temperature, fault, power, message, and zone selection	Signal, temperature, fault, power, and zone selection
Priority sequence (low to high)	BGM, paging mic, siren, message, remote	n/a
Protections	Thermal, short circuit, overload and AC fuses	
Cooling system	Auto temperature controls	
Cut off temperature	75°C	
PHYSICAL		
Dimensions (W x H x D)	482 x 132 x 420 mm	482 x 88 x 420 mm
Weight	10.8 kg	9.3 kg

Packing Information

EVM8810 :

Carton size : 555 (L) x 555 (W) x 230 (H) mm

Gross weight : 12.90 kg

1 unit per carton

EVS8820 :

Carton size : 555 (L) x 545 (W) x 190 (H) mm

Gross weight : 11 kg

1 unit per carton

