

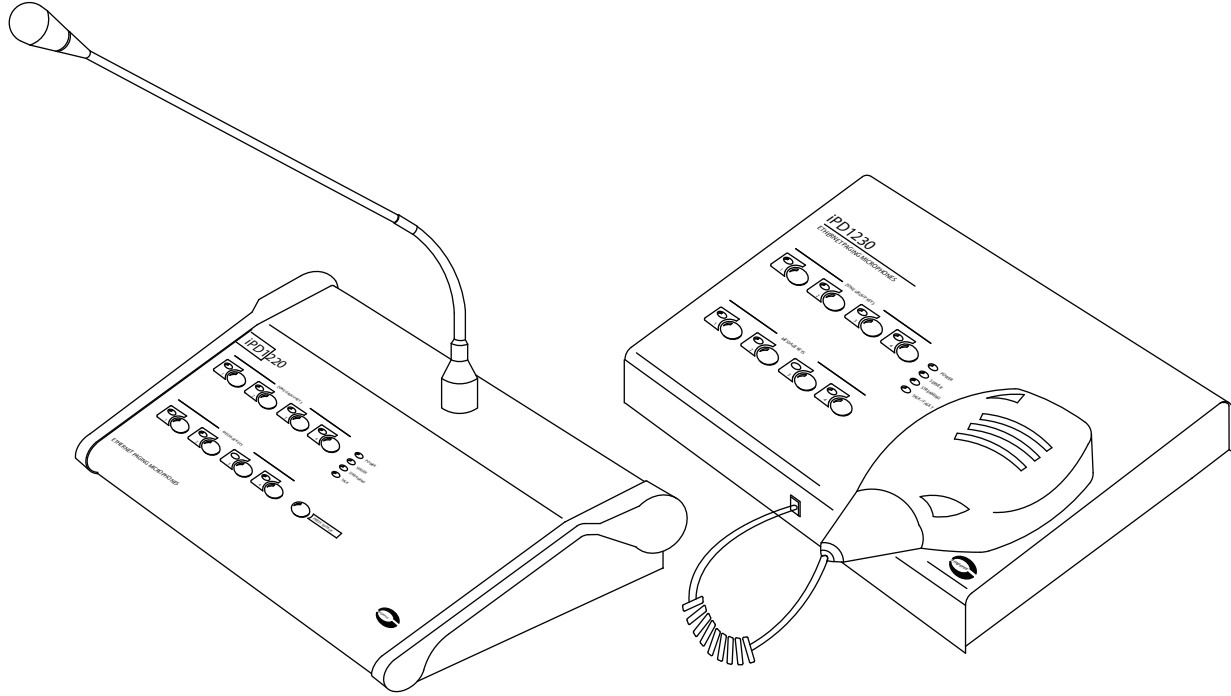

INSTRUCTION MANUAL

iPD1220 / iPD1230

IP Network Paging Microphone
Desktop / Wall Mount



Thank you for choosing another quality product from Amperes Electronics

Product in Summary

iPD1220 and iPD1230 are designed for Amperes IP Paging installation, available in desktop and wall mounted versions. Both have similar features and performance with difference being mounting option and to suit the place of installation. They are used when a local paging is required and programmable to serve only one or several zones designated for the paging station.

Among installations that will need such paging station are but not limited to :

- Hospitals which consists of multiple departments such as pharmacy, registration, clinics etc and would only page the local zone or zones
- Amusement parks or similar which ticketing counters will only be allowed to page counter area
- Airports or similar which a departure gate will only allowed to page zones within the area without affecting other zones
- Factory complexes or similar in which a production line will only page the zone for the particular line.

Each console comes with 4 groups of calling zones which can be programmed at ease. 4 banks of messages provides a convenient for any common or repetitive messages to be broadcasted, such as announcement of closing time, calling of orderly queuing up, etc.

iPD1220 / 1230 can be powered by both local adaptor or via PoE switch, making it a versatile device to be used anywhere within the network.



Scan to view catalogue and latest updates
Ver 1 / 0125

In our support towards environment, we shall no longer print manuals to be accompanied with each product. Please view through browser and print them only when necessary.



Parts Identification

iPD1220

Front View

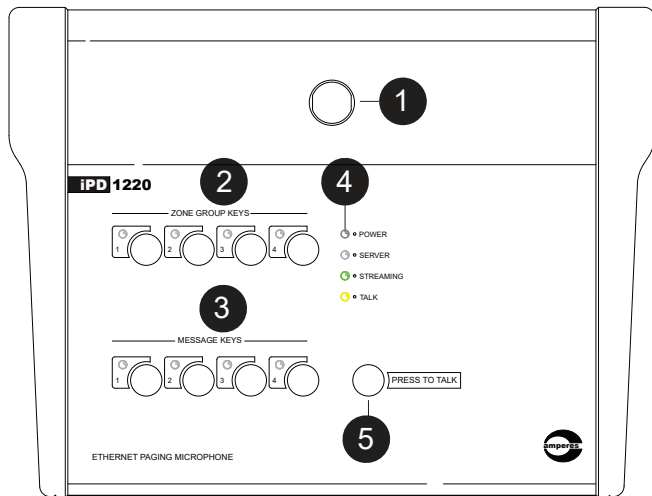

Rear View

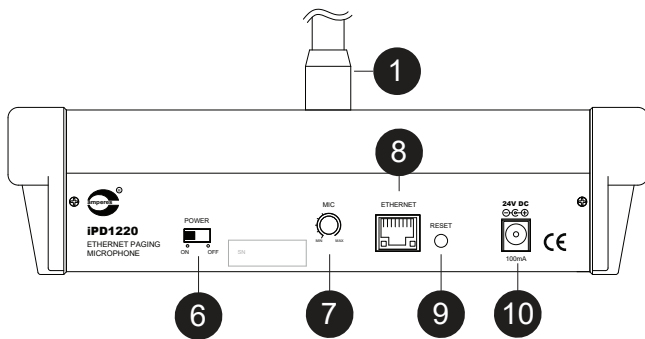

iPD1230

Front View

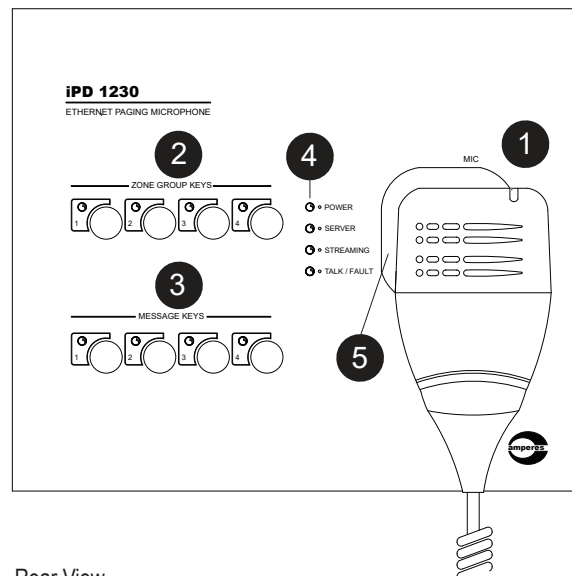

Rear View

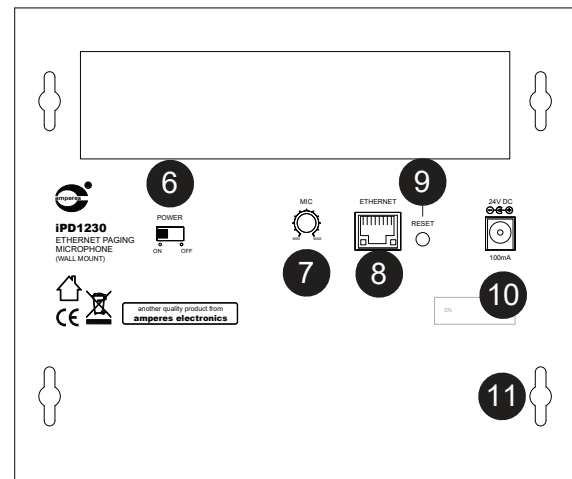

1. GOOSENECK MICROPHONE

The gooseneck microphone provided in iPD1220 is detachable screw type condenser microphone whereas for iPD1230 in handheld condenser mic.

2. GROUP KEYS

4 group keys are available to provide fast paging to a group or group of zones. These buttons can be programmed in the web UI. See the section on Programming Group Zones.

3. MESSAGE BUTTONS

4 message buttons with predefined voice files provide easy broadcast on repetitive messages and can be programmed in the web UI.

4. LED INDICATORS

LED lights to indicate status of power, connection to server, streaming and talk in active.

5. PRESS TO TALK SWITCH

Press this button to start talking after selecting the zone group. The mic will be ready after the chime and with LED at the mic capsule lit.

6. ON / OFF SWITCH

It is used to powering the device.

Parts Identification (Con't)

7. MIC VOLUME KNOB

Adjust the microphone volume with clockwise being increase in volume.

8. ETHERNET PORT

Connect to network switch via this port, either with or without PoE switch.

9. RESET BUTTON

Reset the device by pressing this button for 3 seconds. The previous settings will be lost and return to factory default.

10. DC 24V POWER JACK

Use local 24V power jack if the switch is no PoE. At any one time, use only single power source for the device.

11. MOUNTING SLOTS (iPD1230 ONLY)

The mounting slots are for iPD1230 wall mounting. Please refer to the mounting diagram below

Wall Mounting (iPD1230 only)

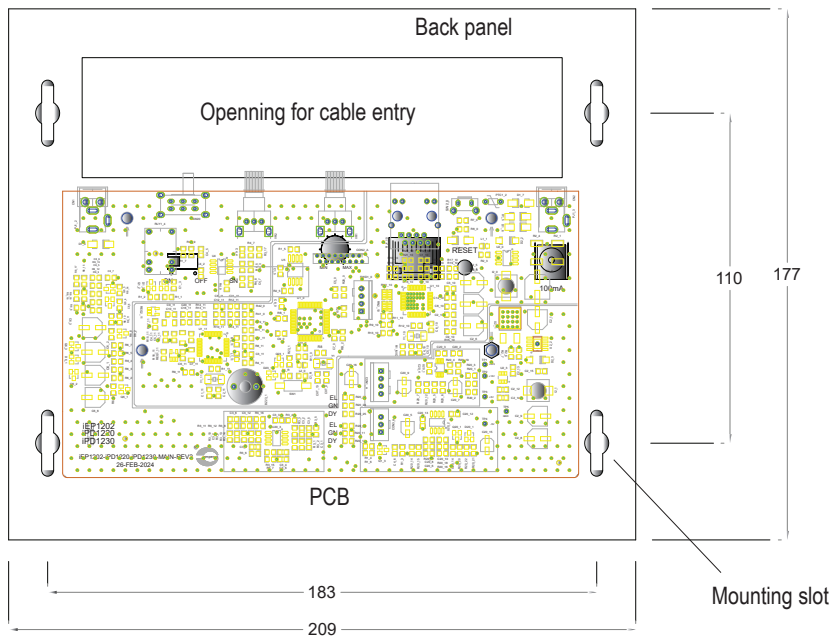

For iPD1230, it is to be mounted on wall.

- Prepare the mounting position by drilling screw holes at the wall with the dimensions as
 - Vertical : 110 mm
 - Horizontal : 209 mm
- Insert wall plug (not included)
- Mount the back panel of iPD1230 to the wall by using M4 screws
- Plug the network cable to the RJ45 network port and power using barrel jack (for non PoE switch)
- Reinstall the front cover to complete the installation.

General Schematic Diagram

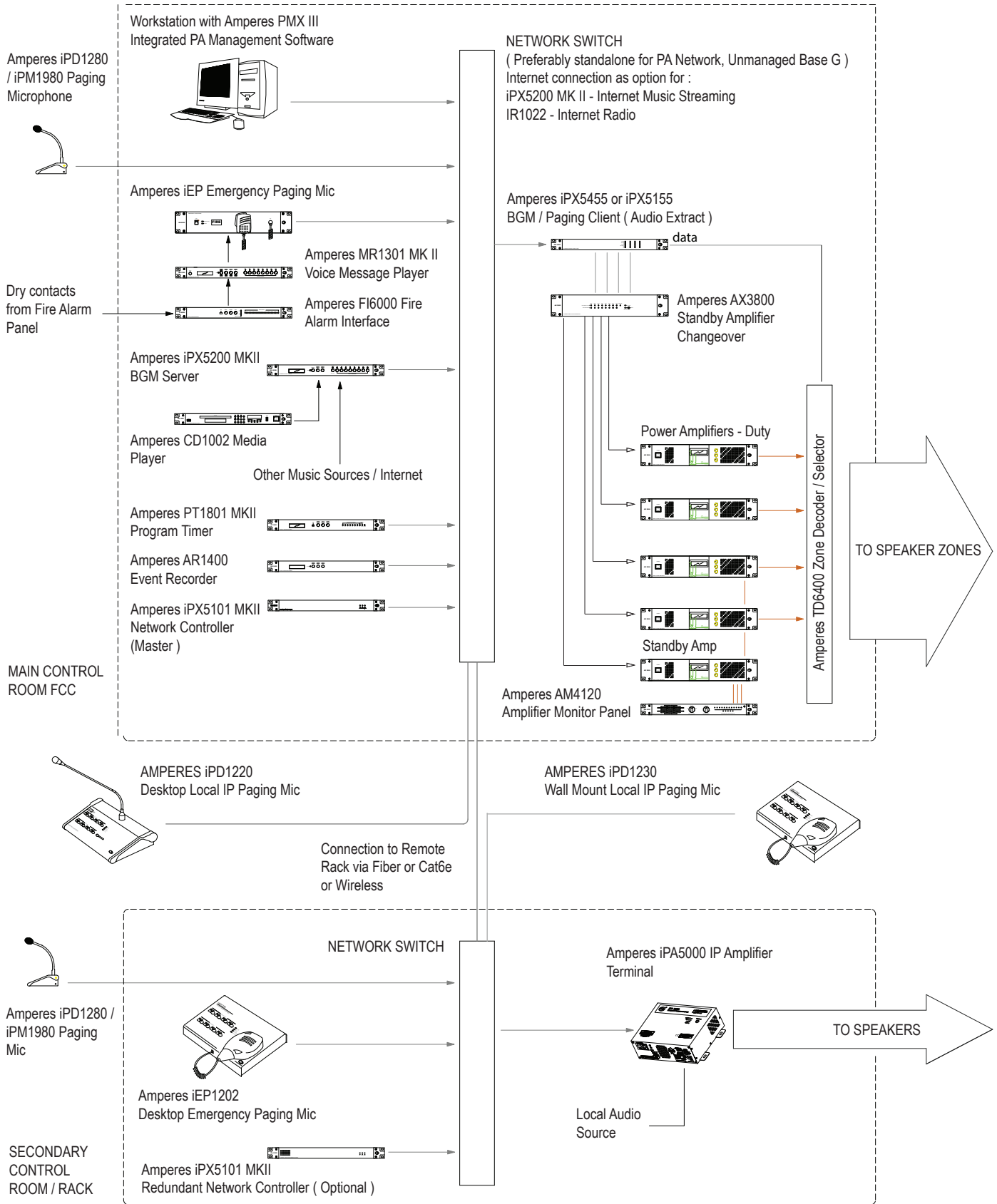

Note :

The above diagram depicts typical connections for an IP setup. Some items are optional. Please consult our technical engineer in proper connectivity or suitable equipment to meet your application.

Connecting the Unit

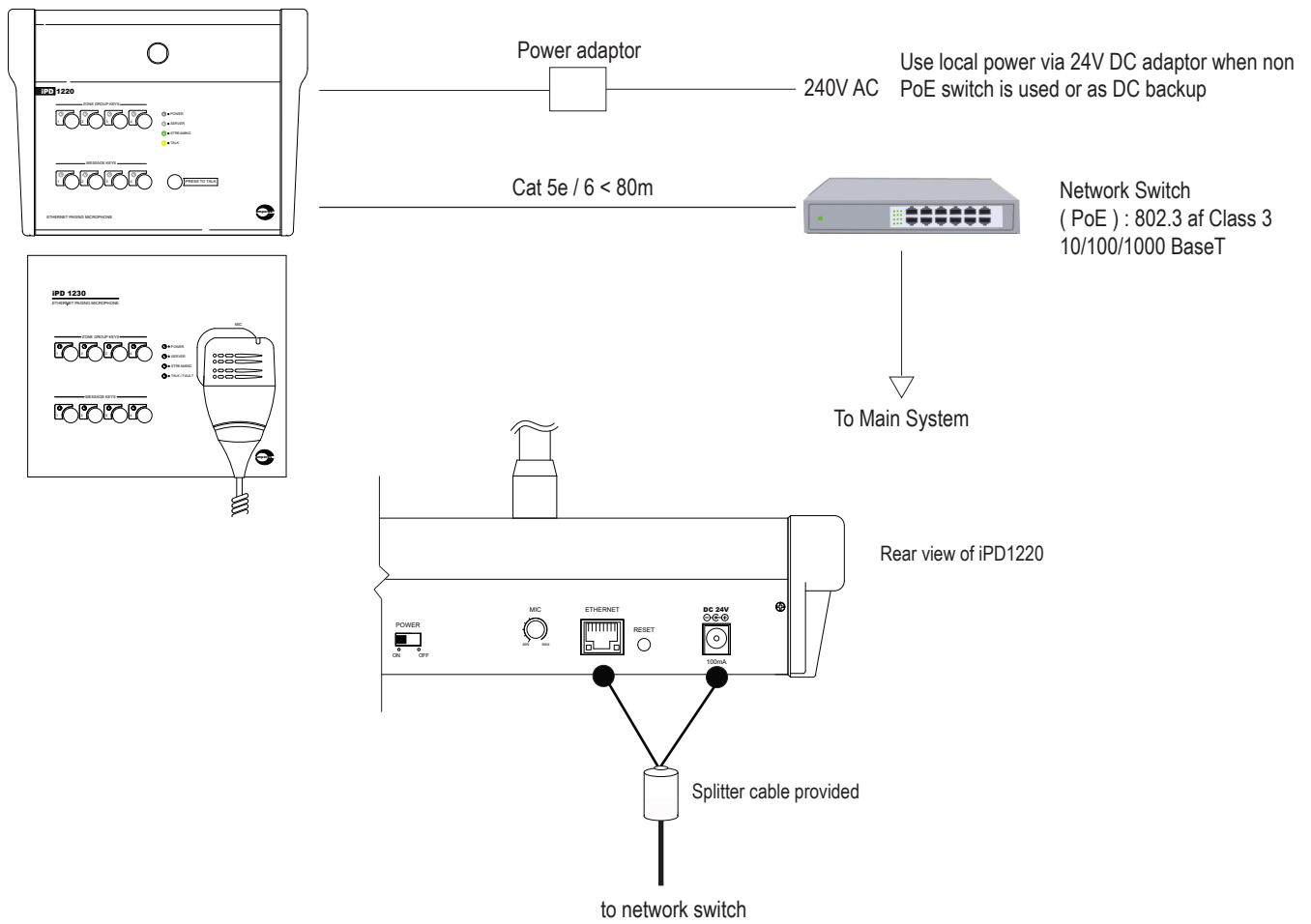

The above is the direct connection of iPD1220 / 1230 to PoE network switch for distance less than 80m.

Longer distance connectivity may require Fiber Optic cable connectivity, either directly or indirectly via network switch with SFP, otherwise, fiber optic converter may be used.

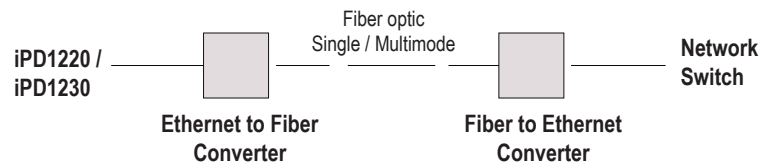

Initial Setting

Before start using the device, some initial setups are required to :

- Assign the IP address
- Assigning the zone grouping keys
- Assigning the message files to message keys

All settings are the be done via the device's web browser page.

Device Setup via Browser

Initial setup required are for network configuration and group / message keys assignments. Enter the web browser with the default address as 192.168.0.100, there after enter the user name and password, both being "admin". You can change the user ID and password.

DEVICE INFO

Device Info

Device Information

Firmware Version	1.03
Serial Number	00000000000000000000
Build Date	02 Apr 2024
Device Name	iPD1220

Network Information

MAC Address	72:6A:76:10:73:45
IP Address	192.168.0.122
Subnet Mask	255.255.255.0
Gateway Address	192.168.0.1
Data Port	3005

Paging Server Status

Server Name	iPX5101 MKII
Server IP	192.168.0.201
Server Version	1.13

This page provides information related to the devices such as :

Device Information

- Firmware version number which can be updated
- Serial number and its build date
- The device name which can be change to provide unique name

Network Information

- Device's MAC address
- Network connectivity information

Paging Server Status

- The devices connectivity with the related server, in case there are more than one server in the system

NETWORK CONFIGURATION

Network Configuration

IP4 Configuration

IP Address	192.168.0.122
Subnet Address	255.255.255.0
Gateway Address	192.168.0.1
Data Port	3005

SAVE

This page allows you to change the IP address of the device to suit the overall network settings.

KEY CONFIGURATION : ZONE GROUP KEYS

Key Configuration

PROGRAMMABLE ZONE KEYS

Zone Group Key 1: ALL CALL CUSTOM

Zone Group Key 2: ALL CALL CUSTOM

Zone Group Key 3: ALL CALL CUSTOM

Zone Group Key 4: ALL CALL CUSTOM

10-12

Key in zone numbers

SAVE

There are 4 zone triggering buttons that can be configured to specific zone, or group of zones or as All Call.

Device Setup via Browser

KEY CONFIGURATION : MESSAGE KEYS

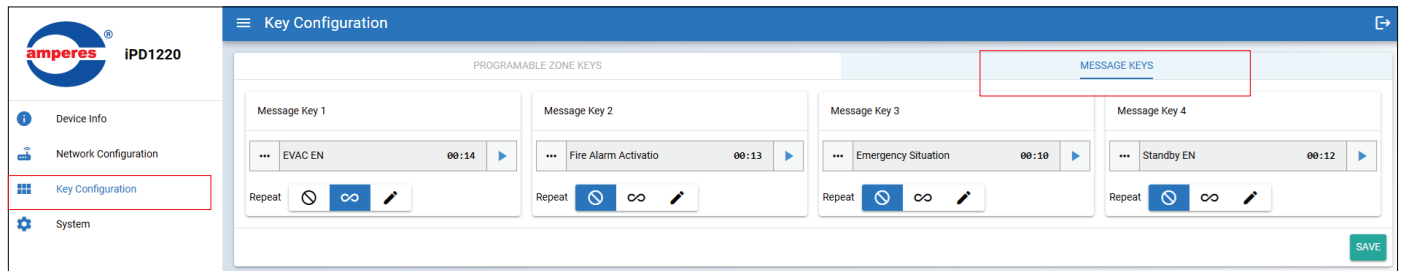

This section is to configure the message buttons. Each button can be loaded with a file of 90 seconds length at maximum. You can preview the loaded file and listen via PC before saving the configurations.

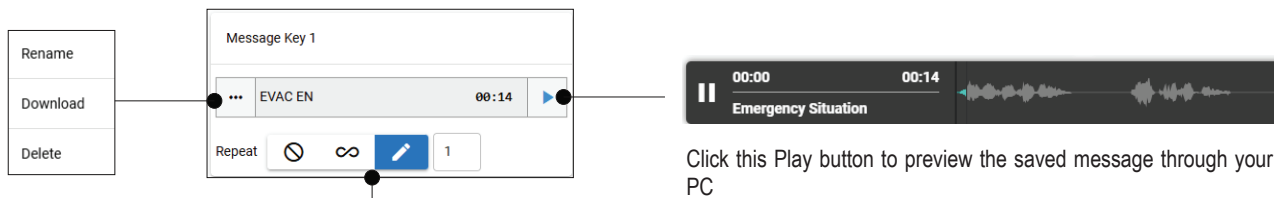

Click to show the drop down menu to rename the file / message, to upload a new file or to delete existing one.

You can configure the message to play once (no repeat), repeat continuously or for specific number of times via this button.

It is required to delete the existing saved file prior to uploading a new one.

SYSTEM : UNIT CONFIGURATION

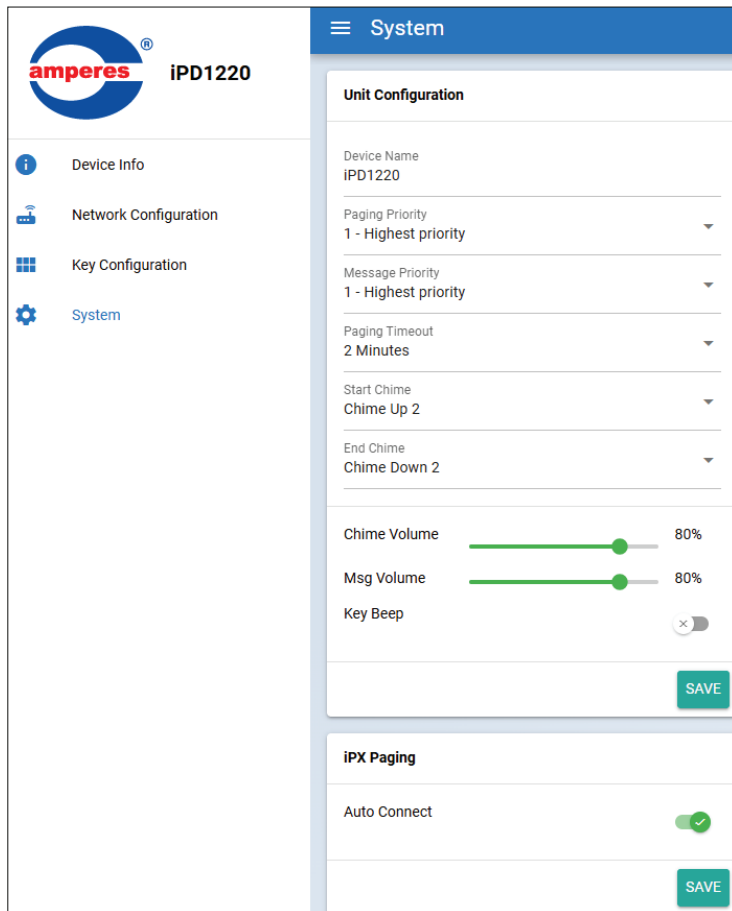

Unit Configuration

User is allow to configure how the device will function or shown in iPX5101 connectivity page.

- Device name provides unique identification of the unit
- Paging and message priority determines which device is allowed to activate when several paging mics are activated at the same time
- Paging time out ensures the device will be automatically shut down to avoid unnecessary broadcast in the event that the user unintentionally left the unit active
- Chime can be set for on or off when mic is activated with it volume for both chime and message. For live paging volume, use the mic volume knob to adjust
- Key beep can be turned on or off

Device Setup via Browser

SYSTEM : UNIT CONFIGURATION : Con't

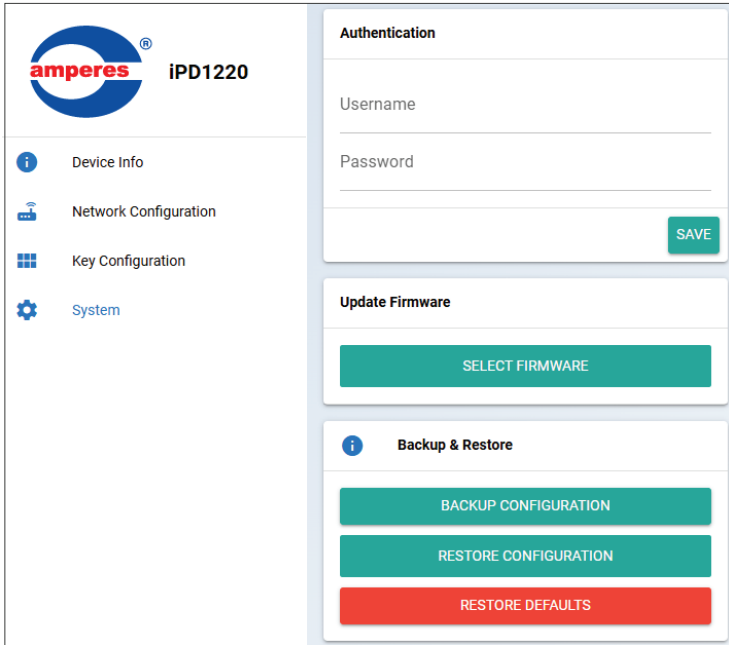

Authentication

- Change the user name and the password

Update Firmware

- Update the devices firmware when required. New firmware shall be available in website

Refer to the section “ Update Firmware ” for more information

Backup & Restore

- Allows back up of current setting as well as restoring the previously set parameters.

Update Firmware

There are 2 methods of updating the devices firmware : Normal and Bootloader mode.

NORMAL FIRMWARE UPDATING

1. Open the browser of the device by using its IP address assigned during the setup.
2. Under “System” page, select “Update Firmware”

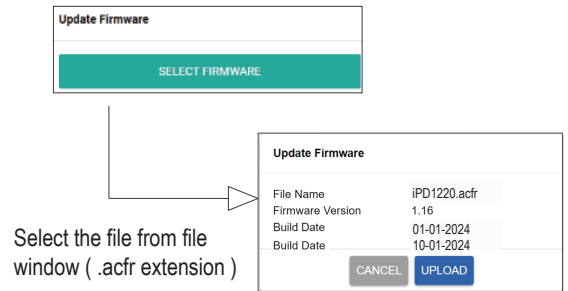

BOOTLOADER FIRMWARE UPDATING

If the device “hanged”, it is required to perform system reset by :

1. Press and hold the “RESET” button until the “STREAMING” LED is on. This will reset the IP address to default address of 192.168.0.100.
2. Open a browser and enter the default address, in which a web page below will appear.
3. Select “Upload Firmware”, choose the correct file with “.acfr” extension and click “Upload”
4. Once the uploading is completed, the browser will enter the login page.

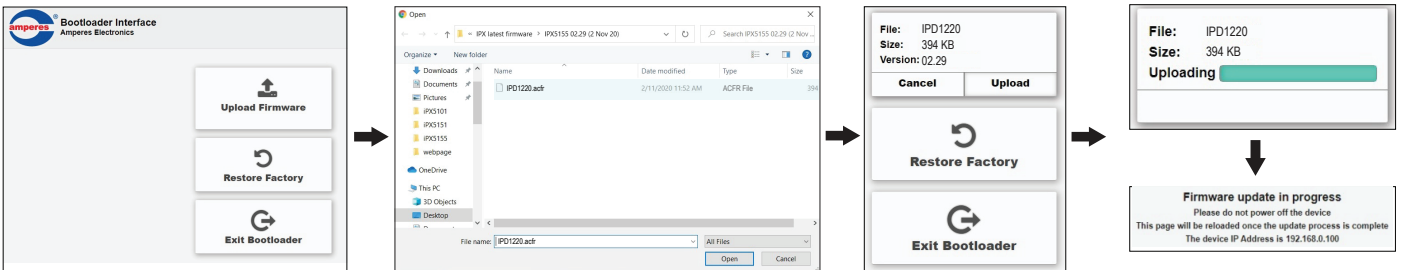

Click Upload Firmware in default IP address at 192.168.0.100

Search the correct file in your PC with “.acfr” extension after obtaining the latest firmware which is available from our website

Click “Upload” to start firmware updating

Upon completion, the browser will automatically restart

Operating the Unit

iPD1220

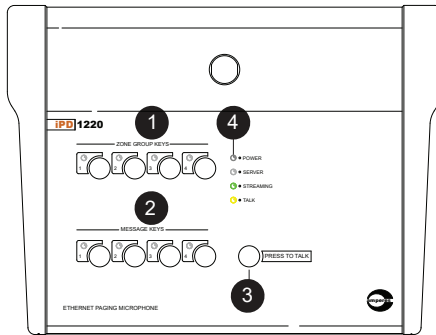

Live Paging

- Press the required buttons at "Zone Group Keys". ① More than one buttons can be selected at any one time.
- Press "Press to Talk" key. ③
- "Talk/Mic" and "Streaming" LEDs ④ will flash when the mic is active and also indicated by the ring LED at the gooseneck mic capsule.
- To end paging, press ③

Message Broadcast

- Press the required buttons at "Zone Group Keys". ① More than one buttons can be selected at any one time.
- Select the message required at message keys. ② Message will start automatically.
- "Talk/Mic" and "Streaming" LEDs ④ will flash
- To end message, press the message button again ②

iPD1230

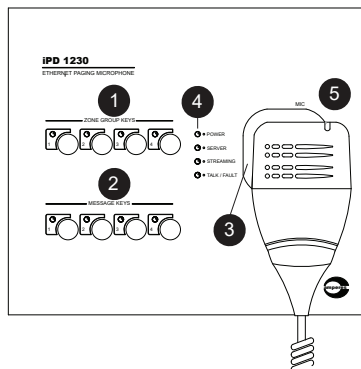

Live Paging

- Press the required buttons at "Zone Group Keys". ① More than one buttons can be selected at any one time.
- Lift up the handheld mic and press the button ③ to start paging.
- "Talk/Mic" and "Streaming" LEDs ④ will flash when the mic is active and also indicated by the LED at the handheld mic. ⑤
- To end paging, release ③

Message Broadcast

- Press the required buttons at "Zone Group Keys". ① More than one buttons can be selected at any one time.
- Select the message required at message keys ② and will start to broadcast.
- To end message, press the message button again.

Technical Specifications

	iPD1220	iPD1230
Operating voltage	24V DC	
Current consumption	0.1 A (2.4W)	
Voltage source	Local adaptor / PoE	
Microphone	Gooseneck	Handheld
Connectivity	10 / 100 Base T	
Protocols	Unicast / Multicast	
Transmission mode	TCP/IP, UDP, IGMP, http	
Zone grouping	4	
Zones per group	8 / All Call	
Message group	4	
Message durations	590 Seconds total	
Max file	20 nos	
File format	MP3 64 k bits/s	
User interface	Google Chrome V90+	
Operating temperature	-10 to 60 C	
Humidity	80%	
Dimensions (excl mic) mm	248 x 65 x 190	220 x 180 x 40
Weight	900 g	950 g

Warranty Conditions

Only Amperes Electronics Service Centres are allowed to make warranty repairs : a list of Amperes Electronics authorized service centres may be asked by the purchaser or send directly to Amperes Electronics Sdn Bhd at 70 Jalan Industri PBP3, Tmn Perindustrian Pusat Bandar Puchong, 47100, Puchong, Selangor. This warranty is not valid if repairs are performed by unauthorized personnel or service centres.

Eligibility

Amperes Electronics' Service Center will accept any device send in for repair / checking purchased from any of our dealers. Some dealers may have the right to refuse repair / service / checking for any device not purchased from them directly.

Coverage

This warranty covers only repairs and replacement of defective parts, due to defects of components or workmanship during product warranty period. For any product purchased exceeding the warranty period, a cost of repair shall be presented and will only proceed to rectifications upon agreed value. If the owner decides not to proceed, a minimal checking fees will be applied.

Exclusions

This warranty does not cover damages caused by misuse, negligence in application as well as using the product with power supply voltage other than shown on the product, or any other power supply source / adapter not recommended by the manufacturer.

This warranty does not cover damages caused by fire, earthquakes, floods, lightning and every cause not directly related to the unit.

This warranty certificate is valid only for the described product, and is not valid if modifications are made on this certificate or identification labels applied to the unit or any other modifications to the physical unit other than its intended usage.

Duration / Warranty Period

This warranty covers all the material and manufacturing defects and is valid for a period of 36 months from the date of purchase or for a specified period in countries where this is stated by a national law. In this case, the extension is valid only in the country where the product is purchased.

Cost of Claiming Warranty

Cost and risk of transportation as well as removal and installation of the product from the main system are for the account of the purchaser. This warranty shall not extend to the replacement of the unit.

Limitations

This warranty does not include any indemnity in favor of the purchaser or the dealer for the period out of use of the unit, moreover the warranty does not cover any damages which may cause to the people and things during the use of the product. Our liability is limited to the cost of the product

Amperes Electronics Sdn Bhd is not obliged to modify previously manufactured products under warranty if the design changes or improvements are made.

The purchaser is deemed to agree to the above warranty conditions once the product packaging is unpacked., Otherwise the product shall be returned to the seller in proper original condition.

Disclaimer

Information contained in this manual is subjected to change without prior notice and does not represent a commitment on the part of the vendor. Amperes Electronics Sdn Bhd shall not be liable for any loss or damages whatsoever arising from the use of information or any error contained in this manual.

It is recommended that all services and repairs of this product to be carried out by Amperes Electronics or its authorized service agents.

Amperes products must only be used for the purpose they were intended by the manufacturer and in conjunction with this operation manual.

Amperes Electronics Sdn Bhd cannot accept any liability whatsoever for any loss or damages caused by service, maintenance or repair by unauthorized personnel, or by use other than that intended by the manufacturer.



Registered to certificate: 16895/ A/ 0001/ UK/ En



AMPERES ELECTRONICS SDN BHD
MADE IN MALAYSIA
Published : JAN 2025